

CUSTOMER COPY

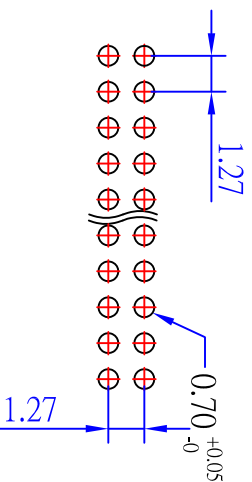
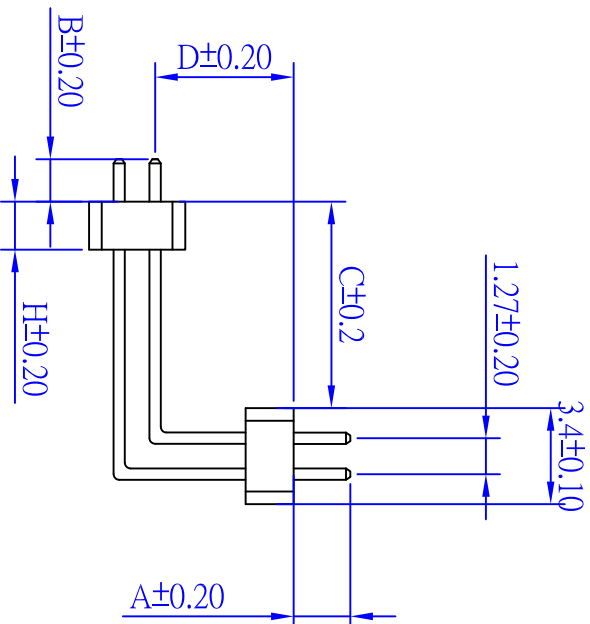
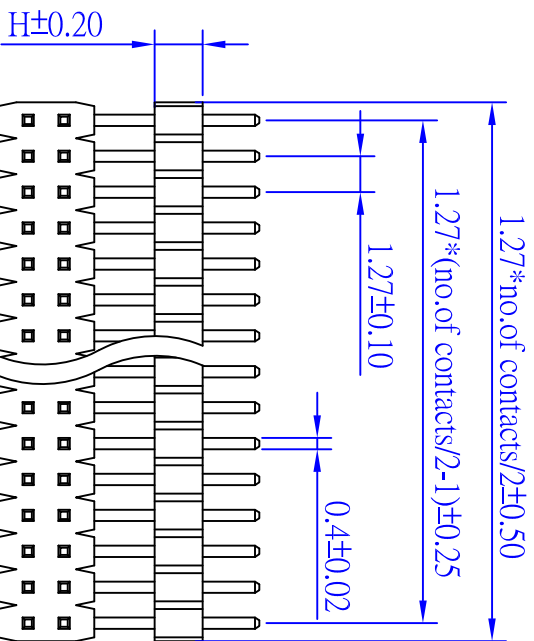

No.	A	B	C	D	H
00	2.00	1.50	5.80	4.90	1.70
01	3.50	2.00	9.30	5.40	2.00
02	3.00	3.00	1.46	2.33	1.00
03	3.20	2.50	18.0	8.00	1.00
04	3.00	3.00	1.77	2.83	1.00

Recommended P.C. Board
Hole Layout

REV.	DESCRIPTION	APP.	DATE
A	NEW DESIGN		

ORDER INFORMATION

171 70 XX XX X

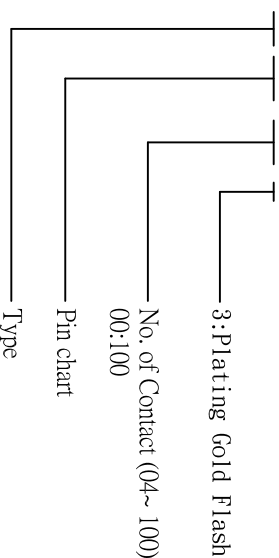

SPECIFICATION

MATERIAL

- * Current Rating: 1 A
 - * Withstanding Voltage: 500 VAC (1 min.)
 - * Insulation Resistance: 5000 Megohms MIN.
 - * Contact Resistance: 30 Milliohms MAX.
 - * Operating Temperature: -40°C to +105°C
 - * Retention Force:
- * Contact: Brass
- * Insulator: High temperature plastic
- * Plating: Gold

鈺滿榮企業股份有限公司 ACME LUX CO., LTD.
TEL.:886-2-85124595 FAX:886-2-85124322

0.0±0.30	SCALE: 1:1	TITLE:	PART NO: 108600
0.00±0.20	UNIT: mm	Pitch 1.27x1.27mm R/A Dual Base	APP BY: Hung
0.000±0.1		Dual Row Pin Header Connector	CHK BY: Cheryl
DWG. NO. C17170XXXXXX		DR BY: Amos	